

TeamTec

teamtec.no

Genuine Spare Parts for Incinerators

Contact us

SPARES@teamtec.no



Spares for Burner

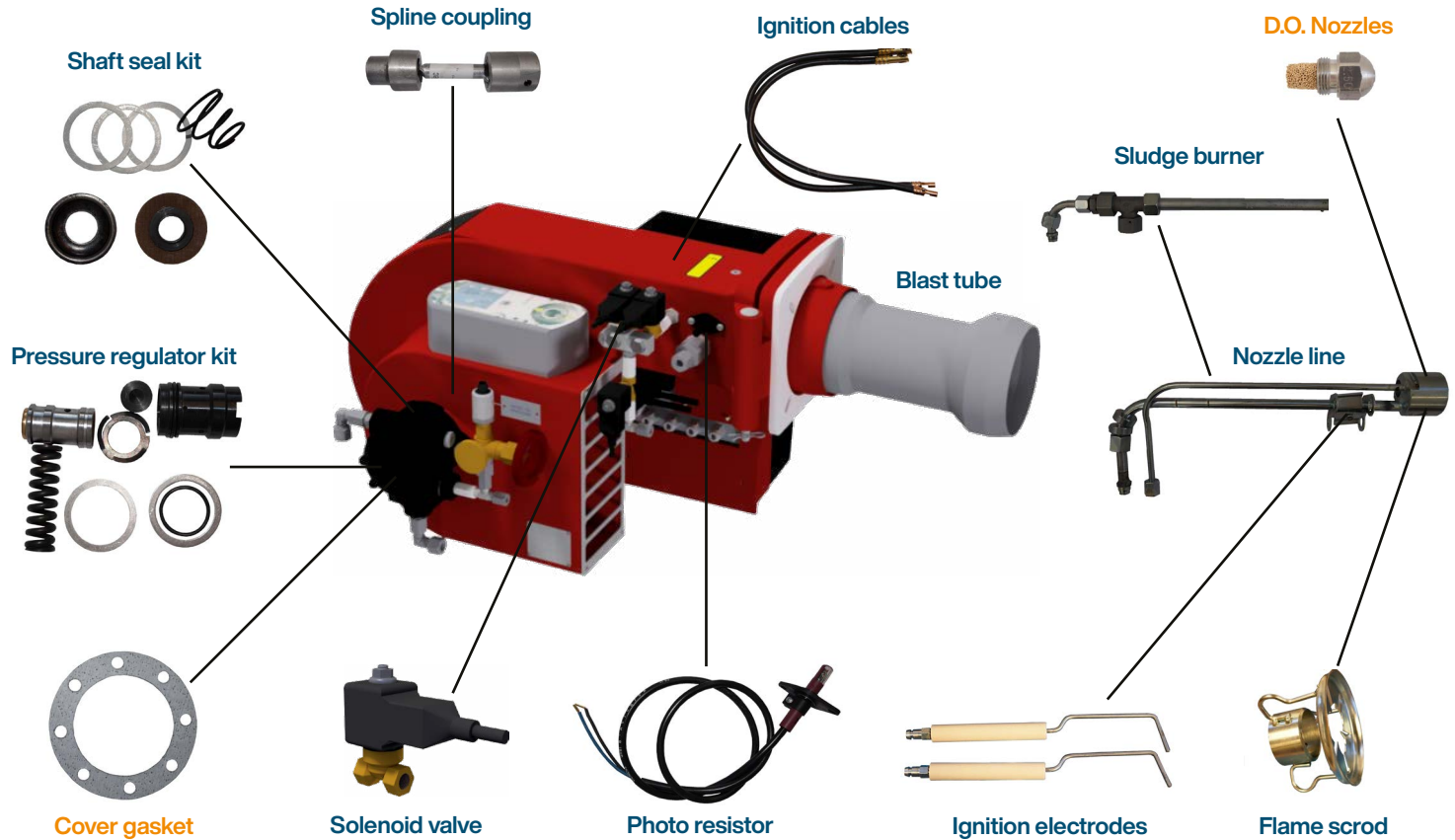

ORANGE TEXT: One year wear and tear parts
BLUE TEXT: Recommended onboard repair parts

Spares for Combustion Chamber

Restriction ring

Thermocouple "N"

Door gasket

Repair material

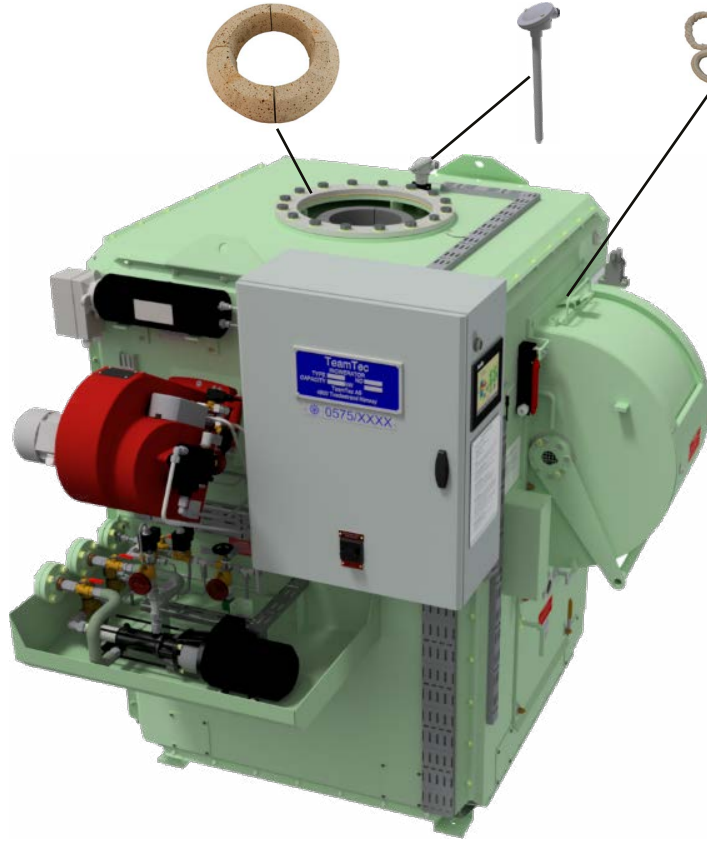

SPARES FOR FLUE GAS FAN

Shaft bearings

Thermocouple "K"

V-belts

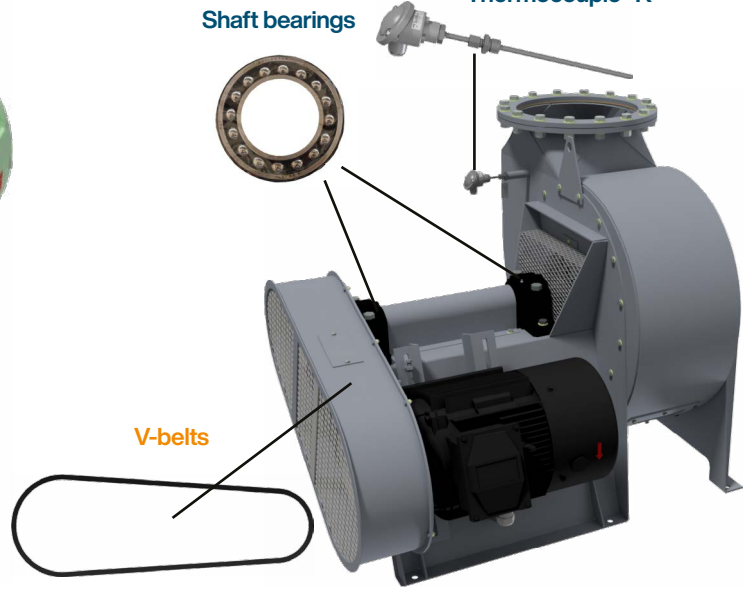

ORANGE TEXT: One year wear and tear parts
BLUE TEXT: Recommended onboard repair parts

Spares for Sludge Dosage Assembly

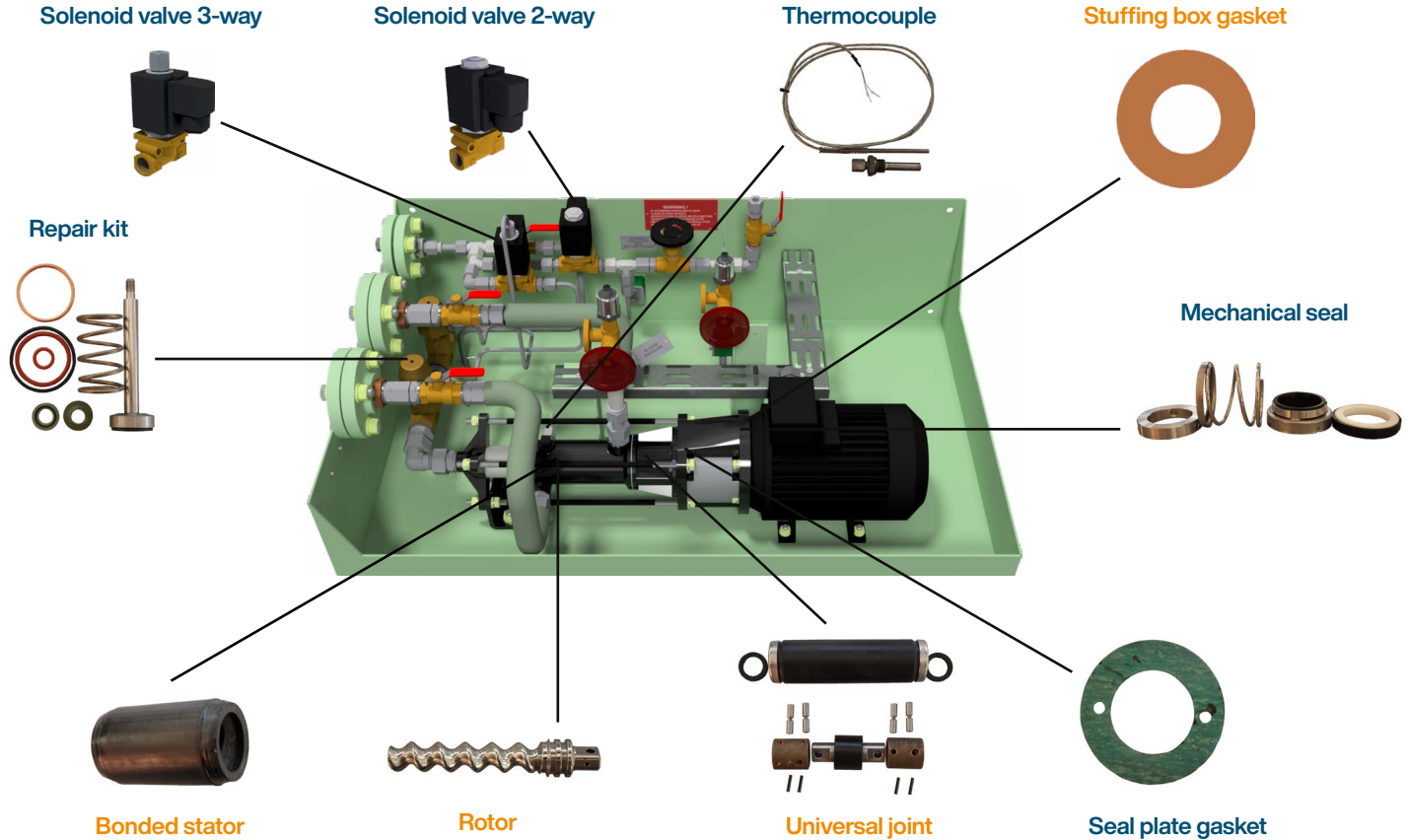

ORANGE TEXT: One year wear and tear parts
BLUE TEXT: Recommended onboard repair parts

One Year Wear and Tear Parts Kit - General List

Spares for burner

- **Diesel nozzle I**
- **Diesel nozzle II**
- **Cover gasket**

Spares for Sludge Dosage Pump

- **Bonded stator**
- **Rotor**
- **Universal joint**
- **Stuffing box gasket**

Spares for Combustion Chamber

- **Glass fibre rope (door gasket)**
- **Sealing compound (glue for door gasket)**
- **Thermocouple “N”**

Spares for Flue Gas Fan

- **V-belts**

The exact content depends on incinerator model, TeamTec Generation (TG) and production year.

One Year Wear and Tear Parts Kit

- **Contains spare parts that should be changed during one year operation**
- **These spare parts should be replaced regularly with normal preventive maintenance**

Recommended Onboard Repair Parts Kit

- **Contains spare parts to be kept onboard at any given time for unforeseen events**
- **Most common causes of downtime can be eliminated**
- **Consumed spare parts should be replaced**

Recommended Onboard Repair Parts Kit - General List

Spares for Burner

- Flame scrod
- Blast tube
- Ignition electrodes
- Ignition cables
- Nozzle line
- Sludge burner assembly
- Pressure regulator kit
- Photo resistor
- Solenoid valve
- Spline coupling complete
- Shaft seal kit

Spares for Sludge Dosage assembly

- Sludge valve
- Solenoid valve 2-way
- Solenoid valve 3-way
- Seal plate gasket
- Mechanical seal
- Stuffing box gasket
- Thermocouple with pocket

Spares for Combustion Chamber

- Repair substance for refractory
- Flue gas restriction ring bricks

Spares for Flue Gas Fan

- Thermocouple "K"
- Shaft bearings

The exact content depends on incinerator model, TeamTec Generation (TG) and production year.

TeamTec

Teamtec AS
N-4902 Tvedestrand | NORWAY

office@teamtec.no
+47 37 19 98 00

